

B (1:2)

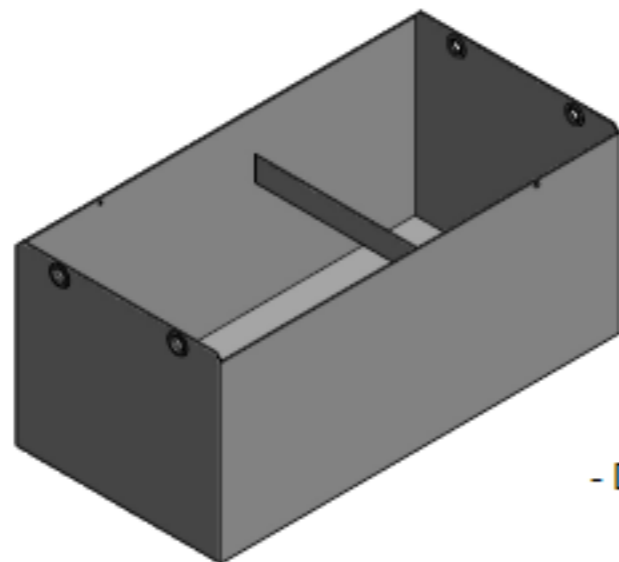

Pos	RAL 7016	RAL 1028	RAL 2002	RAL 9010	RAL 9005	RAL 6018	CELL TYPE	L	W	C	H1	H2	H4	T	Weight ±5%
1							2 PzS 180	1027	256	140	447	462	340	4	46 kg
2							4 PzS 320		436	250					58 kg
3							5 PzS 400		526	304					65 kg
4							6 PzS 480		616	356					70 kg
5							7 PzS 580		706	410					76 kg
6							8 PzS 640		796	464					81 kg
7							4 PzS 380		436	250					65 kg
8							5 PzS 450		526	304					71 kg
9							6 PzS 540	1027	616	356	522	537	450	4	78 kg
10							7 PzS 630		706	410					84 kg
11							8 PzS 720		796	464					90 kg
12		0270973					3 PzS 375	1027	346	196	612	627	500	4	67 kg
13							4 PzS 500		436	250					74 kg
14		0284707		0263703		0270784	5 PzS 625		526	304					81 kg
15		0274574				0270781	6 PzS 750		616	356					88 kg
16							7 PzS 875		706	410					94 kg
17							8 PzS 1000		796	464					101 kg
18	0256173	0256116					3 PzS 485		350	196					121 kg
19	0256774	0263099			0269628		4 PzS 620		440	250					133 kg
20		0253734	0256722				5 PzS 775	1032	530	304	769	784	550	6	144 kg
21		0263100					6 PzS 930		620	356					156 kg
22							7 PzS 1085		710	410					167 kg
23							8 PzS 1240		800	464					180 kg

REMARK

- Dimensions without coating