

B (1:4)

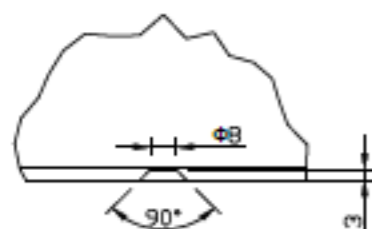

A (1:2)

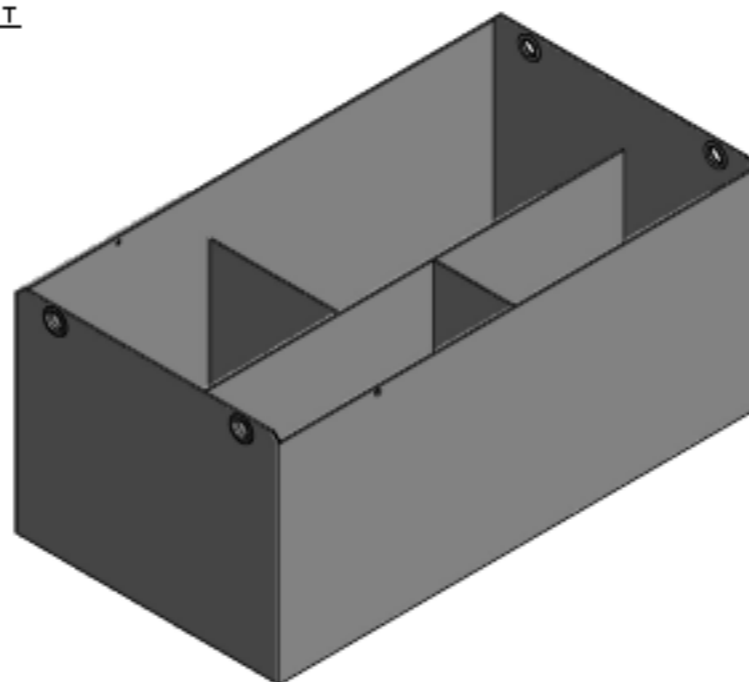

### REMARK

- Dimensions without coating

Pos	CELL TYPE	L	W	C	D	H1	H2	H3	T	Weight ±5%
1	3 PzS 180	1023	561	400	405	387			5	90 kg
2	3 PzS 240		561	400						99 kg
3	4 PzS 320	1023	705	450	405					112 kg
4	5 PzS 400		849	500		447	462		5	125 kg
5	6 PzS 480		993	600			340			138 kg
6	7 PzS 560	1031	1137	700	410					150 kg
7	8 PzS 640		1281	800						163 kg
8	4 PzS 360		705	450						127 kg
9	5 PzS 450	1023	849	500	405	522	537		5	141 kg
10	6 PzS 540		993	600			450			158 kg
11	7 PzS 630	1031	1137	700	410					173 kg
12	8 PzS 720		1281	800						184 kg
13	3 PzS 375		561	400						129 kg
14	4 PzS 500	1023	705	450	405					144 kg
15	5 PzS 625		849	500		612	627		5	160 kg
16	6 PzS 750		993	600			500			176 kg
17	7 PzS 875	1031	1137	700	410					193 kg
18	8 PzS 1000		1281	800						207 kg
19	3 PzS 465		564	400						175 kg
20	4 PzS 620	1025	708	450	405					196 kg
21	5 PzS 775		852	500		769	784		6	217 kg
22	6 PzS 930		996	600			550			238 kg
23	7 PzS 1085	1034	1140	700	410					260 kg
24	8 PzS 1240		1284	800						281 kg